



Redmayne Arnold & Harris
estate agents, letting agents & surveyors

rah.co.uk



TO LET



93 Roseford Road, Cambridge, CB4 2HB

£1,990 PCM

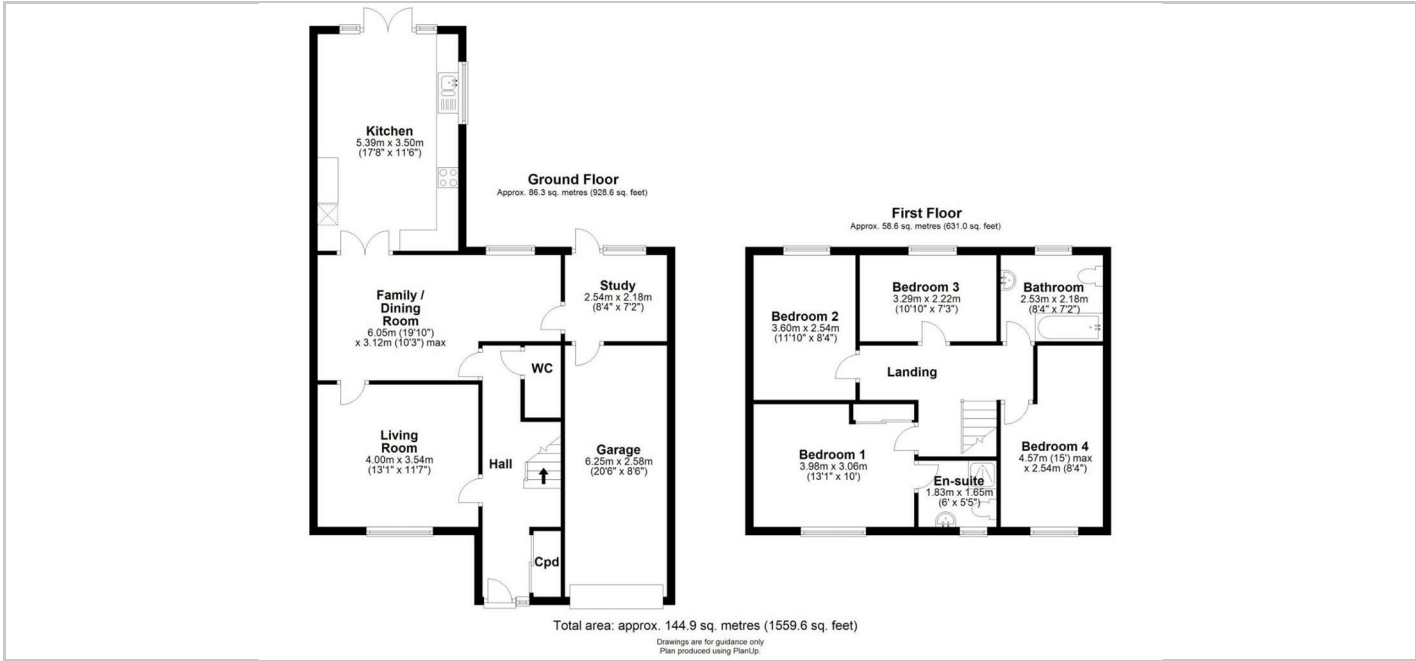

Directions

THE PROPERTY

A well presented 4 bedroom family home, located within easy reach of the A14, Science Park and Cambridge North Station. The property benefits from new carpets throughout and has been newly redecorated. To the ground floor is living room, leading to dining room, kitchen/breakfast room, study and W/C. To the first floor are three double bedrooms and a single bedroom, with en-suite to master, and a family bathroom. There is a good size garden to rear, driveway for two cars and garage. The Property will be managed by RAH. Council Tax Band - E. EPC Rating - C. Available from 11th January 2023.

12 month tenancy
Deposit £1990

SITUATION

